

X 50 FLAT optoSiC+inclusiv glued SM-mount for 7 mm shaft

J = 123g*cm²
M = 28.3g

Notes:

1. Dimension from end of the shaft to the center of the clear aperture.
2. Screw size = M2x8mm
3. Nut size = M2
3. Hex Key Size = 1,5mm
4. Recommended screw torque : 0,6Nm
5. Bore-Diameter 7H7

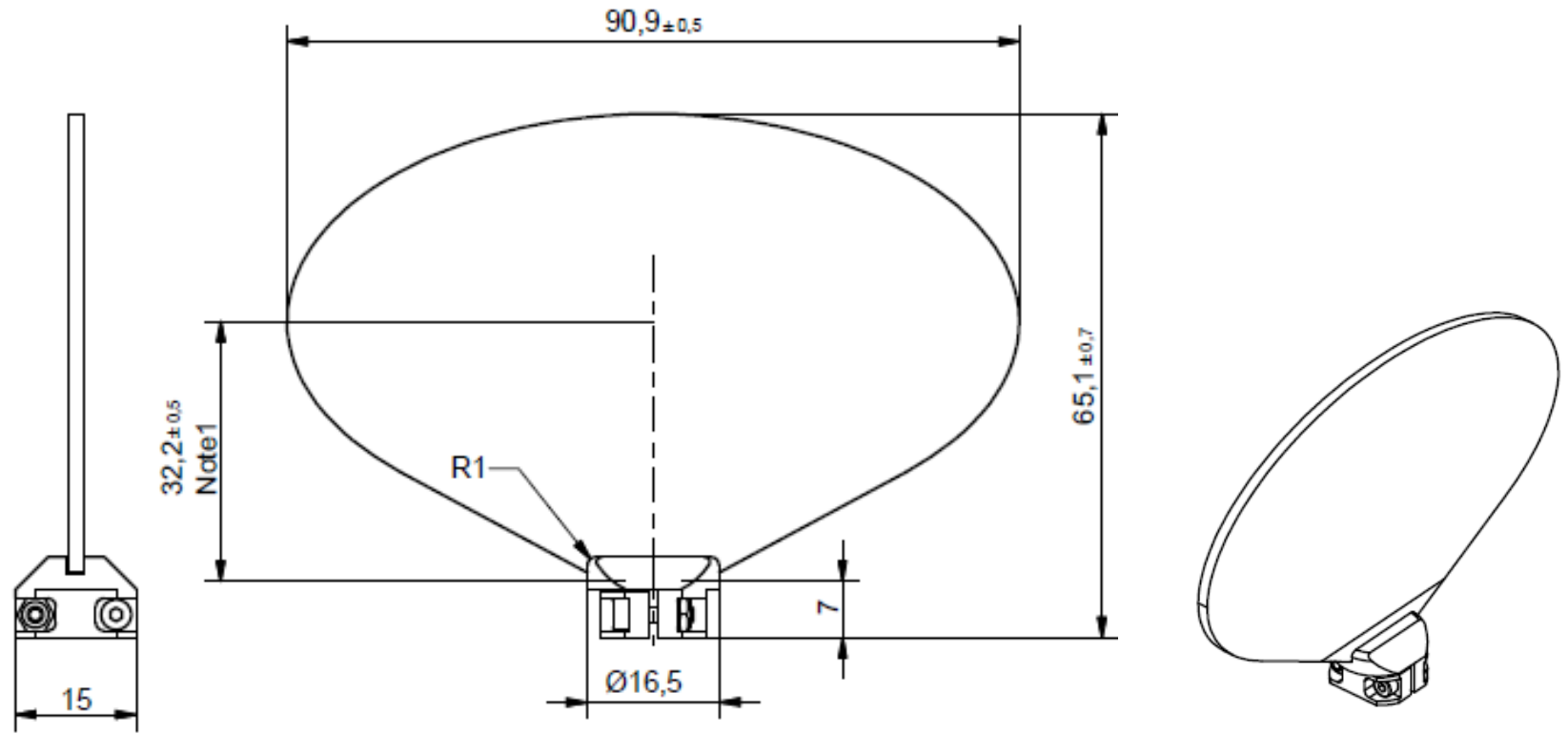

Y 50 FLAT optoSiC+inclusiv glued SM-mount for 12 mm shaft

J = 226g*cm²
M = 69.5g

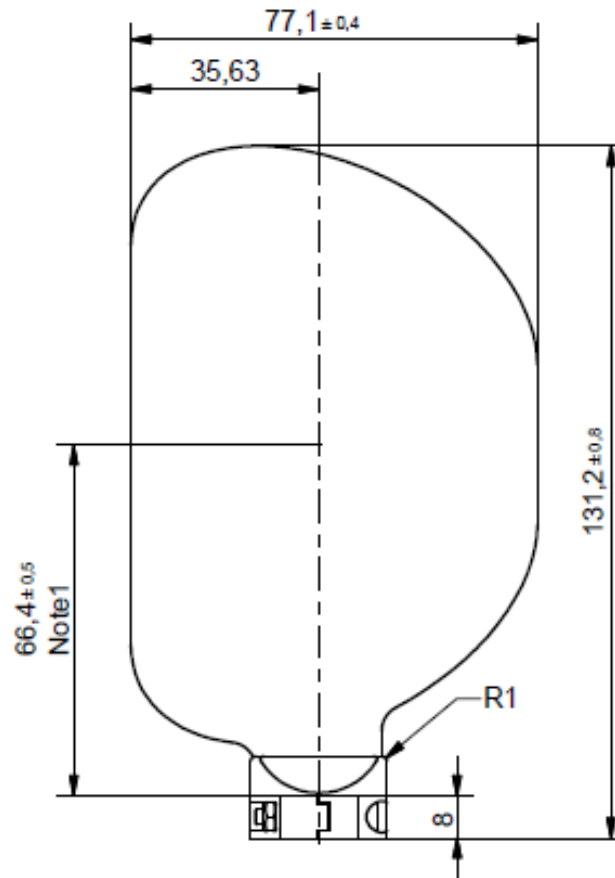
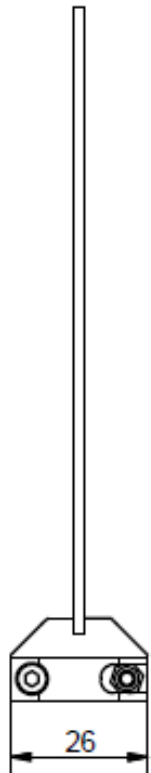

Notes:

1. Dimension from end of the galvo shaft to the center of the clear aperture.
2. Screw size = M3x30mm
3. Nut size = M3
3. Hex Key Size = 2,5mm
4. Recommended screw torque : 1,8Nm
5. Bore-Diameter 12H7

